



## **Ice Machine Parts List for Series G-0600 Cuber Models**

**GR-0600A**

**GD-0603W**

**GD-0602A**

**GY-0604A**

**GR-0692N**

**GY-0694N**

**GY-0605W**

**R-502 System**

**GR-0601W**

**Manufactured October 1984 through October 1992**

# G-0600 CONTROL BOX

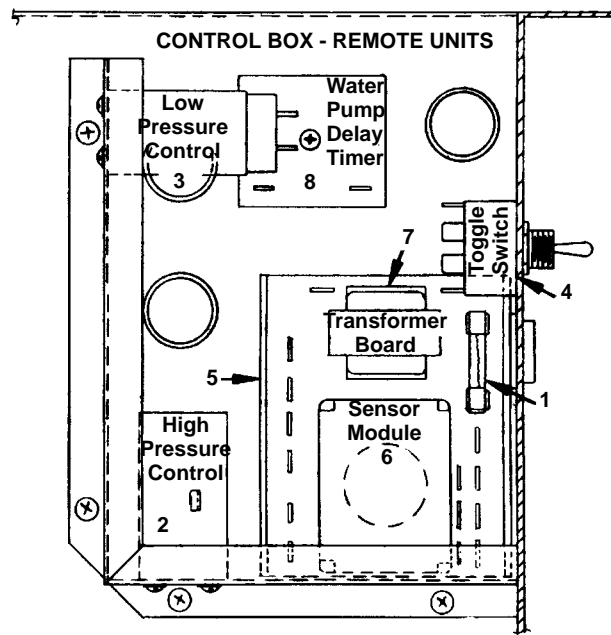
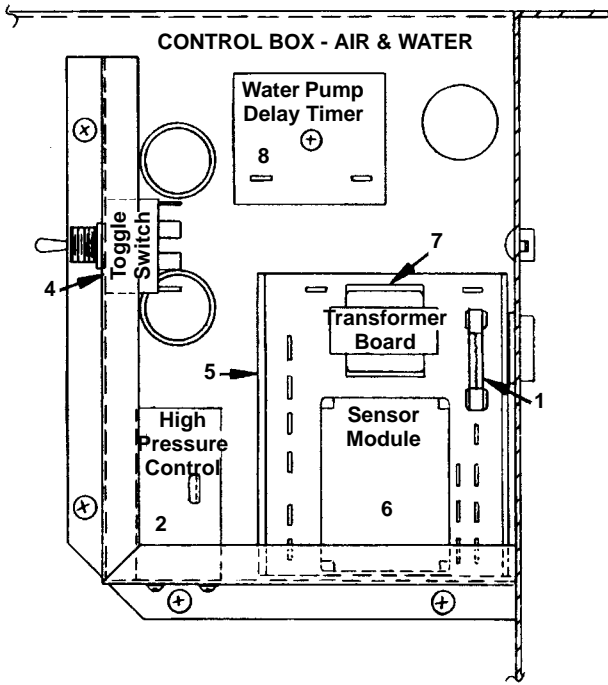

1221

## CONTROL BOX

## PART NO.

- |    |  |                     |
|----|--|---------------------|
| 1  | Fuse   | † 25-1037-9         |
| 2  | High Pressure Cut-out Control Air,<br>Water and Remote<br>Up To SN 870860000 | 23-5521-3           |
|    | After SN 870860000 Use   | † 23-5524-3         |
| 3  | Low Pressure Control (Remote)<br>Up To SN 870860000                          | No Longer Available |
|    | After SN 870860000 Use   | 23-5527-3           |
| 4  | Main Toggle Switch   | † 23-0084-9         |
| 5  | Mounting Track<br>(For transformer board)                                    | 44-0801-3           |
| 6  | Sensor Module Use  | † 76-2375-3         |
| 7  | Transformer Board 230V Use   | † 76-2375-3         |
| 8  | Water Pump Delay Timer   | † 24-0642-3         |
| 9  | Unitized Sensor Board  | † 76-2375-3         |
| 10 | Water Shield Used When Stacking  | 76-2388-3           |

**NOTE:** To replace siphon with water dump solenoid use retrofit #76-2308-3

## UNITIZED SENSOR BOARD

#76-2375-3

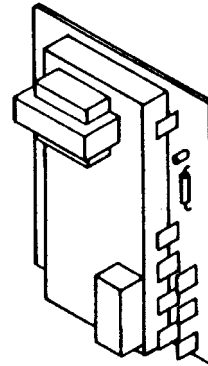

**Unitized sensor board** is used to replace both the transformer board and sensor module

# G-0600 WATER DISTRIBUTION

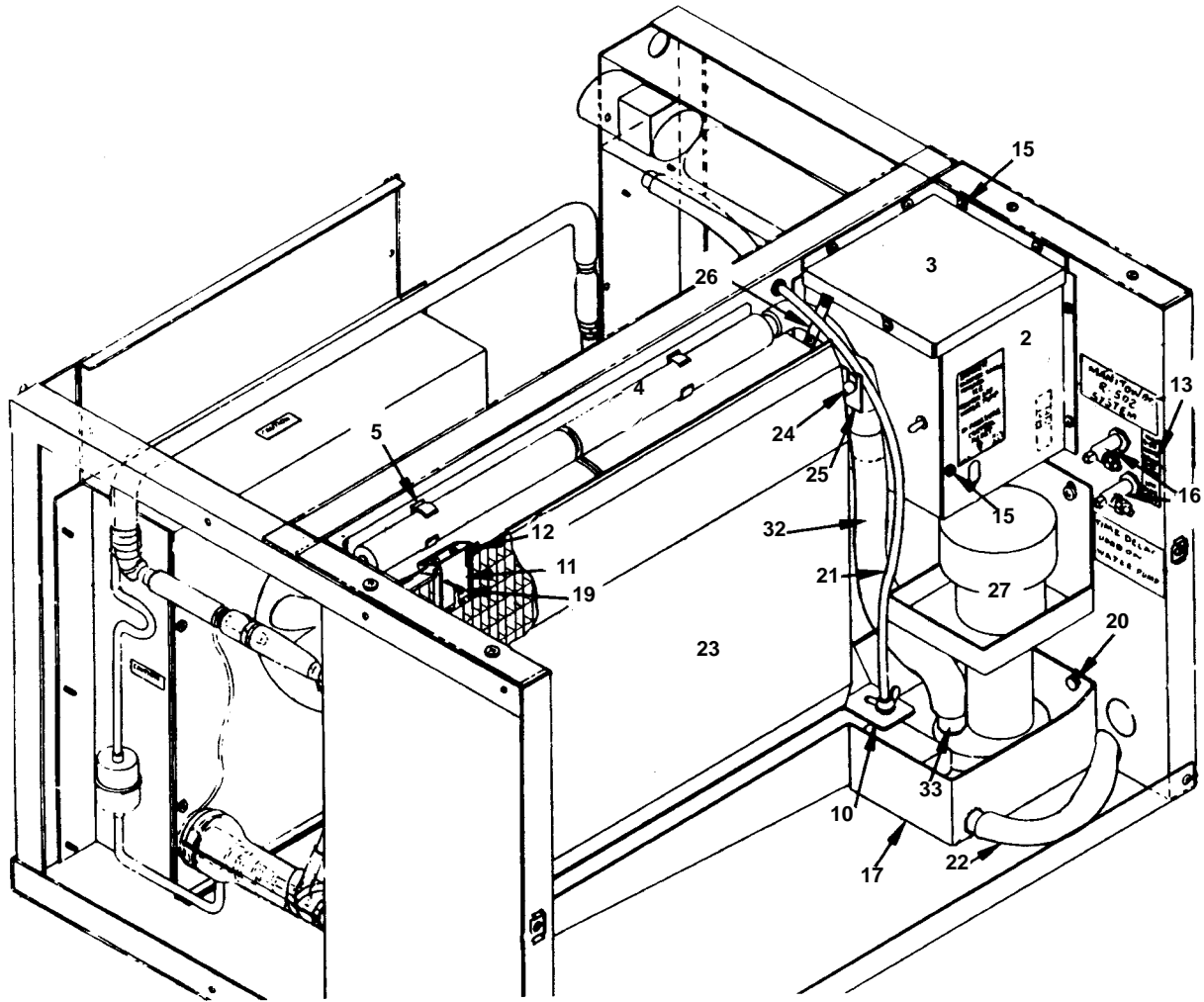

1222

## EVAPORATOR AND WATER DISTRIBUTION

	PART NO.		PART NO.
1	Activating Pin Assembly . . . . .	76-2025-3	
2	Control Box Front Cover . . . . .	† 76-2150-3	
3	Control Box Top Cover . . . . .	† 660771-4	
4	Distribution Tube Assembly . . . . .	76-2153-3	
5	Distribution Tube Spring Clip . . . . .	† 56-5047-9	
6	Evaporator, Regular Cube . . . . .	† 684311-9	
7	Evaporator, Dice Cube . . . . .	† 684321-9	
8	Evaporator, Half Dice Cube . . . . .	† 684331-9	
9	Float Valve . . . . .	† 83-6904-9	
10	Float Valve Bracket . . . . .	† 76-2140-3	
11	Ice Thickness Control . . . . .	† 76-1996-3	
12	Ice Thickness Control - Bracket . . . . .	618581-4	
13	Label (For high and low side service valve) . . . . .	† 81-3147-3	
14	Nylon Nut (For mounting 43-0201-3) . . . . .	† 54-2945-9	
15	Screw 10-24 Phillips Head (Pkg. of 12) . . . . .	† 52-0205-9	
16	Service Valve, High and Low Side . . . . .	† 83-7310-9	
17	Sump Trough . . . . .	686101-4	
18	Sump Trough Support Pin . . . . .	† 43-0201-9	
19	Thumb Screw for Ice Thickness Control . . . . .	† 50-1210-9	
20	Thumb Screw (Mounting sump trough) . . . . .	† 53-0504-9	
21	Tubing, Polyflow 32" Long (Fresh water inlet to float valve) . . . . .		44-2029-1
22	Tubing 1/2" ID, 15" Long . . . . .		† 44-2033-3
23	Water Curtain . . . . .		† 76-1987-3
24	Water Curtain Hanger (White plastic) . . . . .		† 56-5045-9
25	Water Curtain Side Bracket (Set of right and left hand) . . . . .		† 76-2177-3
26	Water Flow Clamp Assembly . . . . .		76-2054-3
27	Water Pump 60 Hz 220V . . . . .		† 76-2601-3
28	Water Inlet Strainer . . . . .		† 12-6003-3
29	Water Pump Lead with Female Plug . . . . .		† 20-7311-3
30	Water Siphon Tube Assembly (See Page 4) . . . . .		No Longer Available
31	Water Tee Break (See Page 4) . . . . .		76-2155-3
32	Pump Discharge Tube (Units using siphon system) . . . . .		† 76-2182-3
	Units with Dump Solenoid Use The Following in Place of 76-2182-3:		
	Vinyl Tubing . . . . .		† 44-2033-3
	Reducer Assembly . . . . .		76-2377-3
33	Pump Discharge Tube Clamp . . . . .		† 56-5053-9

† Refer to Cross Reference Guide

# G-0600 AIR-COOLED

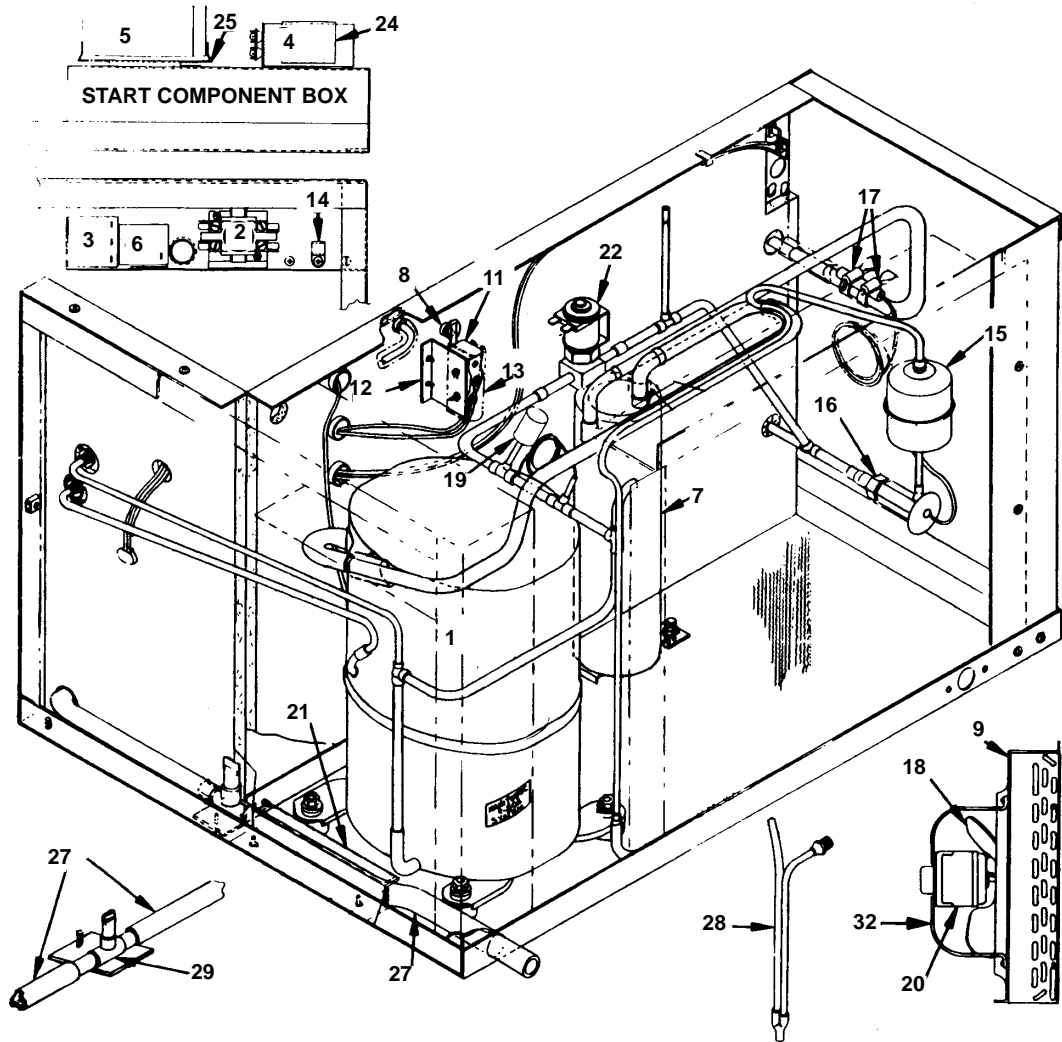

1223

## AIR-COOLED

	<b>PART NO.</b>
1 Compressor Assembly 60 Hz 220V ..	76-0094-3
2 Contactor .....	† 24-1016-9
3 Delay Timer (Air and water) .....	† 24-0635-3
4 Run Capacitor .....	See Page 9
5 Start Capacitor .....	See Page 9
6 Start Relay .....	See Page 9
7 Accumulator .....	No Longer Available
8 Activating Pin Assembly .....	76-2025-3
9 Air Condenser with Shroud ...	No Longer Available
10 Air Condenser Only .....	88-5048-3
11 Bin Switch .....	† 23-0111-9
12 Bin Switch Bracket .....	617531-4
13 Bin Switch Mylar Insulation .....	619961-4
14 Cable Clamp, Nylon .....	† 56-5004-9
15 Drier .....	† 89-3027-9
16 Expansion Valve .....	† 76-2398-3
17 Expansion Valve Stainless Steel Bulb Clamp .....	† 56-5052-9
18 Fan Blade for Motors ESP-OL50EM2 & ESP-OL50EM28 .....	† 24-1608-9
Fan Blade for Motor K33HXCEJ-948 ..	24-1617-3

## AIR-COOLED

	<b>PART NO.</b>
19 Fan Cycle Control .....	23-0115-3
20 Fan Motor .....	† 76-2638-3
21 Hold Down Bracket .....	623471-4
22 Hot Gas Solenoid Valve Assembly ...	76-3010-1
23 Hot Gas Solenoid Valve Coil Only Alco	† 24-0448-3
24 Run Capacitor Bracket .....	623331-4
25 Start Capacitor Bracket .....	85-0309-3
26 Tubing, Polyflow 1/4" .....	44-2029-1
27 Tubing, 1/2" ID .....	† 44-2033-3
28 Siphon Tube Assembly .....	No Longer Available
29 Water Tee Break .....	76-2155-3
30 Water Dump Solenoid Coil Only (Eaton Dole) .....	24-0464-3
30a Water Dump Solenoid (Alco) .....	000001768
31 Dump Solenoid Diaphragm Only (Eaton Dole) .....	24-0468-3
32 Wire Motor Mount .....	34-0621-3
33 Air Baffle .....	† 76-2068-3

**NOTE:** FOR 50 CYCLE PARTS, SEE PAGE 8

† Refer to Cross Reference Guide

# G0600 WATER-COOLED

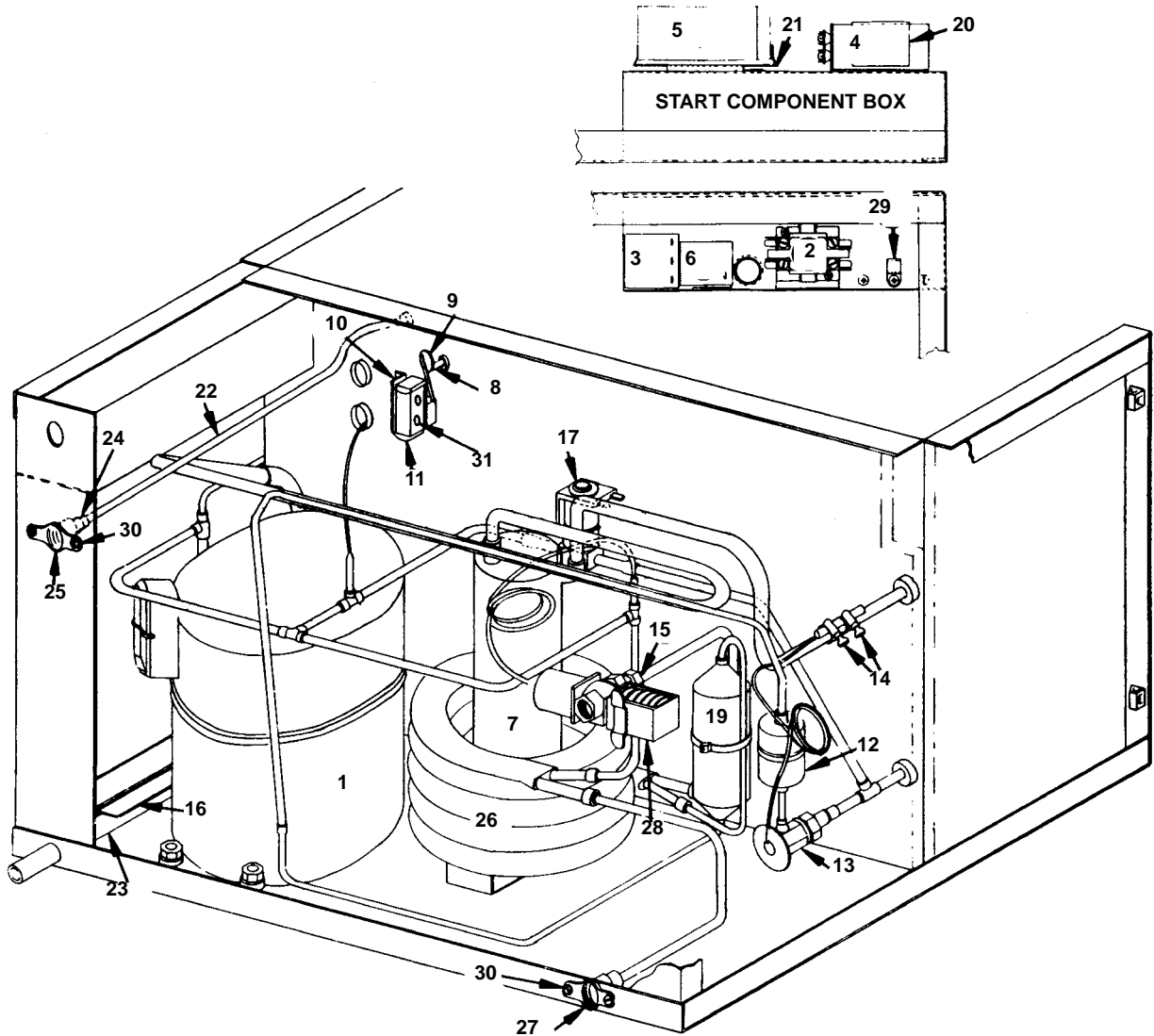

1224

WATER-COOLED		PART NO.	WATER-COOLED		PART NO.
1	Compressor Assembly 60 Hz 220V . . .	† 76-2813-3	17	Hot Gas Solenoid Valve Assembly . . .	76-3010-1
2	Contactors . . . . .	† 24-1016-9	18	Hot Gas Solenoid Valve Coil Only Alco †	24-0448-3
3	Delay Timer (Air and water) . . . . .	† 24-0635-3	19	Receiver . . . . .	12-0003-1
4	Run Capacitor . . . . .	See Page 9	20	Run Capacitor Bracket . . . . .	623331-4
5	Start Capacitor . . . . .	See Page 9	21	Start Capacitor Bracket . . . . .	85-0309-3
6	Start Relay . . . . .	See Page 9	22	Tubing, Polyflow 1/4" . . . . .	44-2029-1
7	Accumulator . . . . .	No Longer Available	23	Tubing, 1/2" ID . . . . .	† 44-2033-3
8	Activating Pin Assembly . . . . .	76-2025-3	24	Union . . . . .	13-6096-1
9	Bin Switch . . . . .	† 23-0111-9	25	Water Adapter . . . . .	600242-1
10	Bin Switch Bracket . . . . .	617531-4	26	Water Condenser . . . . .	† 88-6533-3
11	Bin Switch Mylar Insulation . . . . .	619961-4	27	Water Condenser Outlet Adapter . . . .	87-0610-3
12	Drier . . . . .	† 89-3027-9	28	Water Regulator . . . . .	83-7206-3
13	Expansion Valve . . . . .	† 76-2398-3	29	Cable Clamp, Nylon . . . . .	† 56-5004-9
14	Expansion Valve Stainless Steel Bulb Clamp . . . . .	† 56-5052-9	30	Screw, 0-24 Slot Head . . . . .	† 52-0206-9
15	Half Union Coupling . . . . .	83-3202-3	31	Screw, 6-32 x 1" SHMS . . . . .	† 50-2329-9
16	Hold Down Bracket . . . . .	623471-4	32	Hex Nut for Item 31 . . . . .	† 54-2878-9

**NOTE:** FOR 50 CYCLE PARTS, SEE PAGE 8

† Refer to Cross Reference Guide

# G-0600 REMOTE

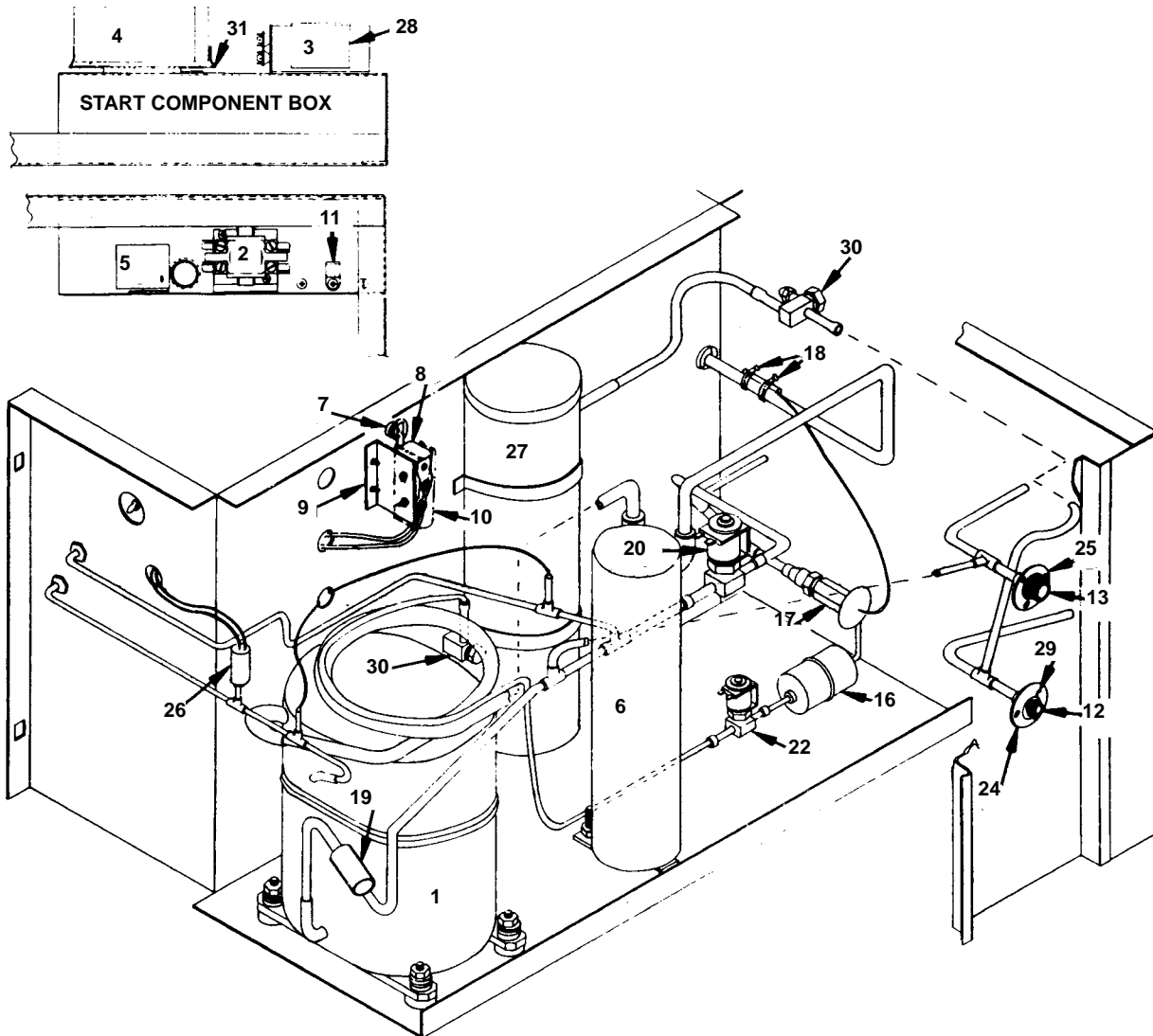

1225

## REMOTE SYSTEM

COMPRESSOR COMPARTMENT	PART NO.
1 Compressor Assembly 60 Hz 220V ..	† 76-2813-3
2 Contactor .....	† 24-1016-9
3 Run Capacitor .....	See Page 9
4 Start Capacitor .....	See Page 9
5 Start Relay .....	See Page 9
6 Accumulator .....	No Longer Available
7 Activating Pin Assembly .....	76-2025-3
8 Bin Switch .....	† 23-0111-9
9 Bin Switch Bracket .....	617531-4
10 Bin Switch Mylar Insulation .....	619961-4
11 Cable Clamp, Nylon .....	† 56-5004-9
12 Coupling 1-1/8" - 12 THD. ....	† 83-6035-3
13 Coupling 1-7/16" - 16 THD .....	† 83-6037-3
14 Coupling "0" Ring for 83-6022-3 .....	† 83-6022-9
15 Coupling "0" Ring for 83-6037-3 .....	† 83-6023-9
16 Drier .....	† 89-3027-9
17 Expansion Valve .....	† 76-2398-3
18 Expansion Valve Stainless Steel Bulb Clamp .....	† 56-5052-9
19 Heater (On discharge line) .....	† 76-2013-3

	PART NO.
20 Hot Gas Solenoid Valve Assembly . . .	76-3010-1
21 Hot Gas Solenoid Valve Coil Only Alco	† 24-0448-3
22 Liquid Line Pump Down Valve Assembly 208/230V 50/60 Hz (Danfoss) .....	† 76-3008-1
23 Liquid Line Pump Down Valve Coil Only Alco .....	† 24-0448-3
24 Mounting Flange 1/2" .....	83-6018-3
25 Mounting Flange 3/4" .....	83-6017-3
26 Pressure Limiter Switch .....	† 23-0116-9
27 Receiver .....	† 76-2958-3
27a Fusible Receiver Plug .....	† 628451-9
28 Run Capacitor Bracket .....	623331-4
29 Screw, 10-24 x 1/2" TC .....	† 52-0206-9
30 Service Valve for Receiver .....	† 83-7316-9
31 Start Capacitor Bracket .....	85-0309-3

## PARTS LOCATED IN REMOTE CONDENSER

Fan Motor .....	† 76-1984-3
Head Pressure Control .....	† 83-6806-9
Female Coupling Kit .....	07-0066-3

**NOTE:** FOR 50 CYCLE PARTS, SEE PAGE 8

† Refer to Cross Reference Guide

**G-0600 REMOTE  
AFTER SN 880961220**

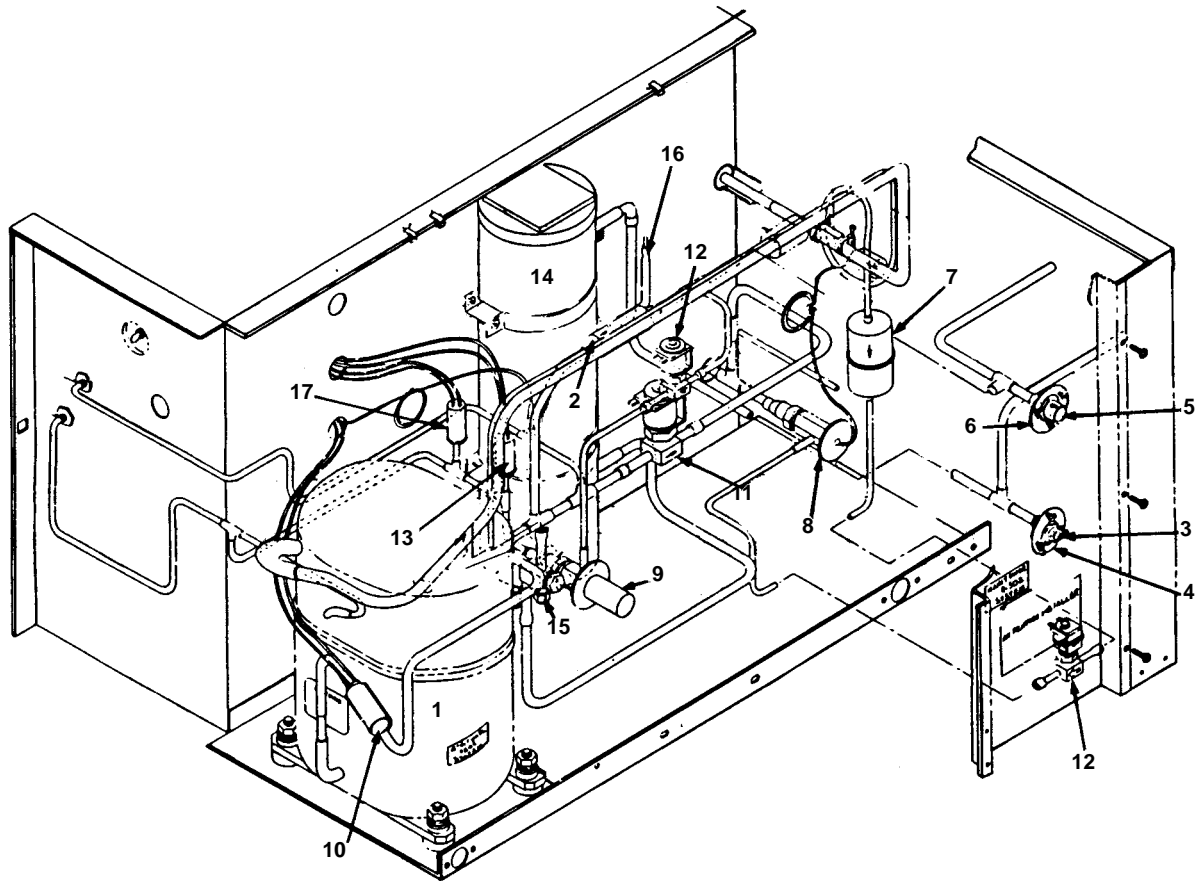

1226

	<b>PART NO.</b>
1 Compressor 60 Hz .....	† 76-2813-3
2 Check Valve .....	† 83-7314-9
3 Coupling 3/8 OD .....	† 83-6035-3
4 Flange .....	83-6018-3
5 Coupling 1/2 OD .....	† 83-6037-3
6 Flange .....	83-6017-3
7 Drier .....	† 89-3027-9
8 Expansion Valve .....	† 76-2398-3
9 HPR Valve .....	83-6731-3
10 Heater .....	† 76-2013-3
11 Hot Gas Solenoid Valve .....	76-3010-1
12 Solenoid Valve 208/230V 50/60 Hz (Danfoss) (Liquid line or harvest assist) .....	† 76-3008-1
13 Low Pressure Control .....	23-5527-3
14 Receiver .....	† 76-2958-3
15 Receiver Service Valve .....	† 83-7316-9
16 Receiver Safety Plug .....	† 628451-9
17 Suction Pressure Limiter Switch (HPL Safety) .....	No Longer Available

† Refer to Cross Reference Guide

## G-0600 OUTER PANELS

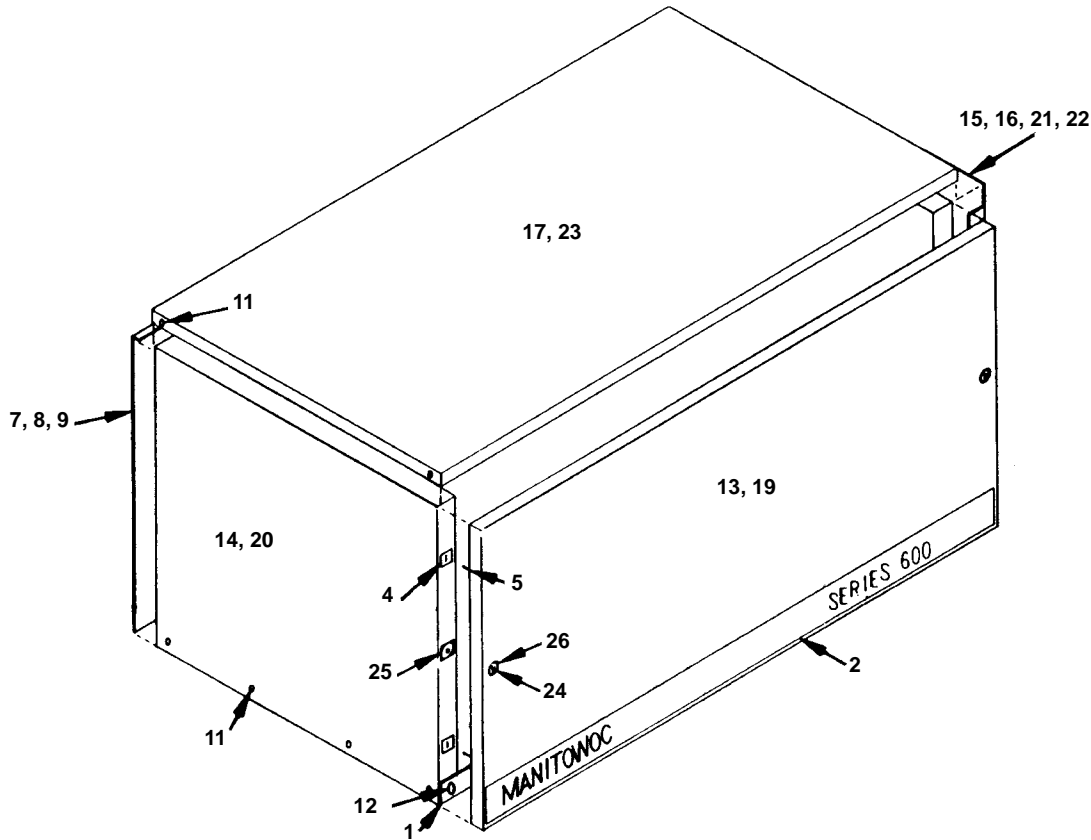

1227

### COMMON PARTS

	PART NO.
1 Front Support Angle . . . . .	† 658041-9
2 Front Panel Trim . . . . .	† 81-3487-3
3 Front Panel Seal . . . . .	† 92-0250-9
4 Front Panel Catches Only (Pkg. of 12)	76-2064-3
5 Front Panel Strike Only (Pkg. of 25) . .	76-2063-3
6 Front Panel Strike-n-Catch (Pkg. of 4 each) . . . . .	76-2029-3
7 Rear Panel (Air-cooled) . . . . .	76-2147-3
8 Rear Panel (Water-cooled) . . . . .	† 76-2148-3
9 Rear Panel (Remote) . . . . .	No Longer Available
10 #10-24 Phillips Head Screw (Mounting control box cover) (Pkg. of 12) . . . . .	† 52-0205-9
11 #10-24 Slot Head Screw (Mounting outer panels) (Pkg. of 12) . . . . .	† 52-0206-9
12 #10-24 Phillips Head Screw (Mounting front angle support) (Pkg. of 12) . . .	† 52-0209-9

### OUTER PANELS — FAWN

	PART NO.
13 Front Panel . . . . .	† 76-1992-3
14 Left Hand End Panel . . . . .	† 686161-9
15 Right Hand End Panel (Remote) . . . .	† 76-2119-3
16 Right Hand End Panel (Air and water)	† 685771-9
17 Top Cover . . . . .	683821-4
18 Fawn Touch Up Paint . . . . .	94-0093-1

### OUTER PANELS — STAINLESS STEEL

	PART NO.
19 Front Panel . . . . .	76-1993-3
20 Left Hand End Panel . . . . .	† 686163-9
21 Right Hand End Panel (Remote) . . . .	† 76-2547-3
22 Right Hand End Panel (Air and water)	† 76-2547-3
23 Top Cover . . . . .	683823-4
24 Fastener Screw (Pkg. of 12) . . . . .	† 50-2668-9
25 Nut Cage (Pkg. of 12) . . . . .	† 54-2910-9
26 Hole Plug (Pkg. of 10) . . . . .	† 43-0155-9
27 Spacer for Front Panel Screw . . . . .	† 37-1819-9

### 50 HZ MODELS ONLY

Use same parts as previously listed for standard G-0600 except for the following:

Unitized Control Board . . . . .	† 76-2396-3
Compressor Assembly . . . . .	76-0093-3
<b>Compressor Start Components (See Page 9)</b>	
Remote Fan Motor (Located in remote condenser) . . . . .	† 76-1985-3
Water Pump . . . . .	† 76-2601-3

† Refer to Cross Reference Guide

## COMPRESSOR COMPONENTS FOR G-0600

### 230V/60 HZ/1 PH

<b>Compressor Model Number</b>	<b>Start Relay</b>	<b>Start Capacitor</b>	<b>Run Capacitor</b>
Tecumseh. . . . .	† 20-0799-3	† 85-0314-3	† 85-0342-3
Bristol M52123BBCB . . . . .	† 76-2610-3	85-0370-3	† 85-0341-3
Bristol M53B982BBCB. . . . .	20-0757-9	85-0314-3	20-1014-3
Copeland RS86CIE-PFV-218 . . . . .	20-0753-9	85-0372-3	20-1014-3
Copeland RS86CIE-PFV-251 . . . . .	20-0753-9	85-0372-3	85-0393-3
Copeland CS08KQE-PFV-255. . . . .	20-0755-9	† 85-0385-3	85-0393-3

### 230V/50 HZ /1 PH

<b>Compressor Model Number</b>	<b>Start Relay</b>	<b>Start Capacitor</b>	<b>Run Capacitor</b>
Tecumseh. . . . .	85-0362-3	† 85-0314-3	† 85-0342-3
Bristol. . . . .	85-0404-3	85-0314-3	85-0393-3
Copeland RS86CIE-PFJ-251. . . . .	20-0755-9	85-0559-3	20-1014-3
Copeland CS08KQE-PF2-255. . . . .	20-0755-9	† 85-0385-3	85-0393-3

† Refer to Cross Reference Guide

# REMOTE CONDENSER AC-0895

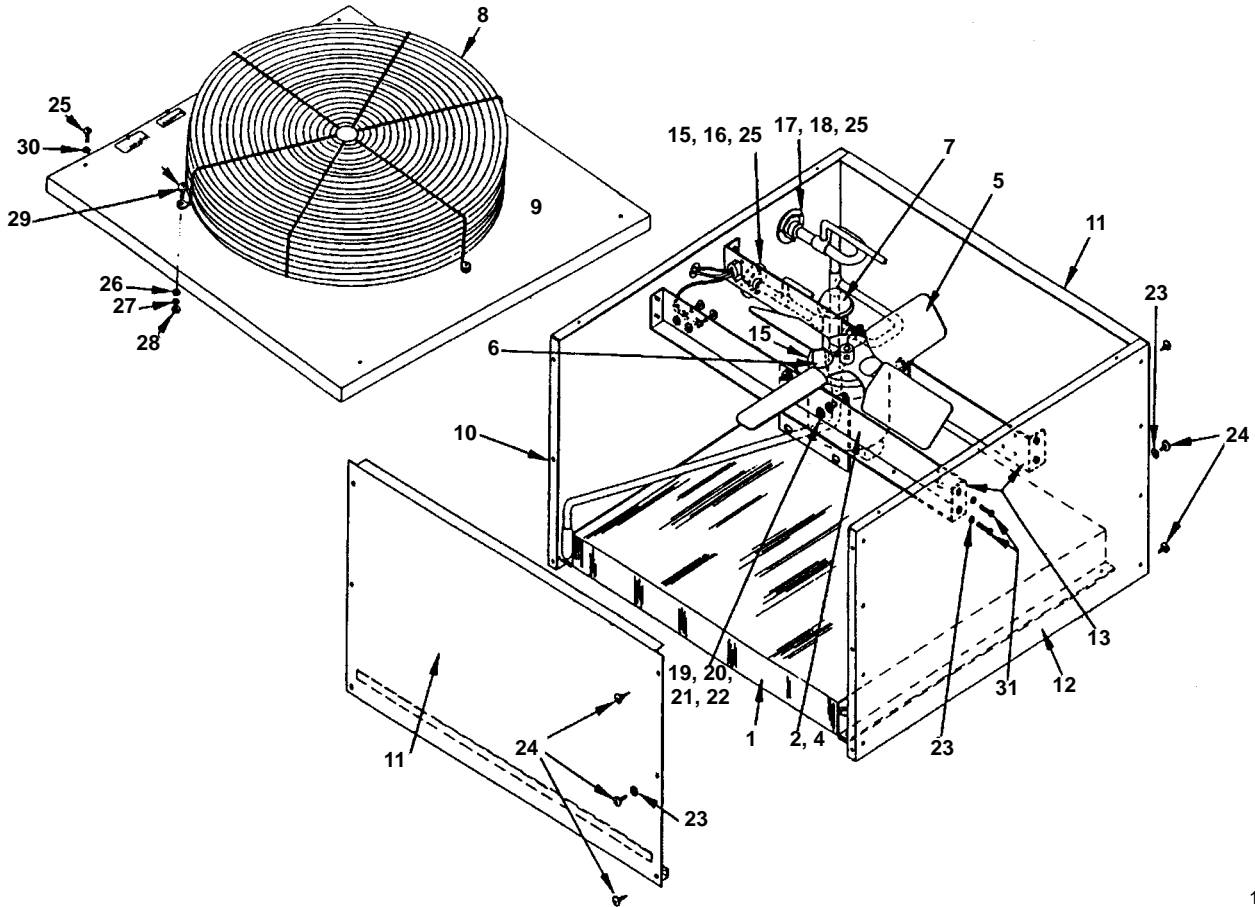

1228

PART NO.		PART NO.	
1	Air Condenser . . . . . † 88-5062-9	17	Coupling Mounting Flange . . . . . 83-6017-3
2	Fan Motor 60 Hz 230V* . . . . . † 76-2941-3	18	Coupling Assembly 1/2 OD . . . . . † 83-6036-3
3	Run Capacitor (Emerson)* . . . . . 85-0335-3	19	Lockwasher 5/16 Split . . . . . † 55-7313-9
3a	Run Capacitor (Magnatec) . . . . . No Longer Available	20	Flatwasher . . . . . † 55-7309-9
4	Fan Blade* . . . . . 24-1611-3	21	Hex Nut 5/16-18 . . . . . † 54-2975-9
5	Fan Motor 50 Hz 230V* . . . . . † 76-2941-3	22	Screw 5/16-18 Hex Head . . . . . † 50-3565-9
6	Rain Shield* . . . . . 24-1505-3	23	Lockwasher #8 . . . . . † 55-4459-9
7	Head Pressure Control . . . . . † 83-6806-9	24	Screw 8-1/2 . . . . . † 51-2153-9
8	Fan Grill . . . . . 34-0064-3	25	Screw, 10-24 x 5/8 . . . . . † 52-0205-9
9	Top Cover . . . . . † 601775-1	26	Hex Nut 1/4-20 . . . . . † 54-2952-9
10	Rear Panel . . . . . † 76-2261-3	27	Flatwasher 1/4" . . . . . † 55-7304-9
11	Panel, Right and Left End . . . . . 76-2231-3	28	Lockwasher 1/4" Split . . . . . † 55-4511-9
12	Front Panel . . . . . † 601772-1	29	Screw 1/2-20 x 5/8 . . . . . † 50-3345-9
13	Bracket, Fan Motor & Base . . . . . † 601768-1	30	Lockwasher #10 . . . . . † 55-4464-9
14	Legs (Condenser mounting) . . . . . † 601769-1	31	Screw, 8-32 x 1/2 . . . . . † 50-2624-9
15	Coupling Mounting Flange . . . . . 83-6018-3	32	Female Coupling Kit . . . . . 07-0066-3
16	Coupling Assembly 3/8 OD . . . . . † 83-6036-3		

\*Early models used a single bracket to mount the fan motor. Those units use the following parts:

Fan Motor 60 Hz 230V . . . . .	† 76-1984-3
Fan Motor 50 Hz 230V . . . . .	† 76-1985-3
Rain Shield . . . . .	No Longer Available
Fan Blade . . . . .	24-1607-3
Run Capacitor . . . . .	24-1502-3

† Refer to Cross Reference Guide

## REMOTE CONDENSER DC-0896

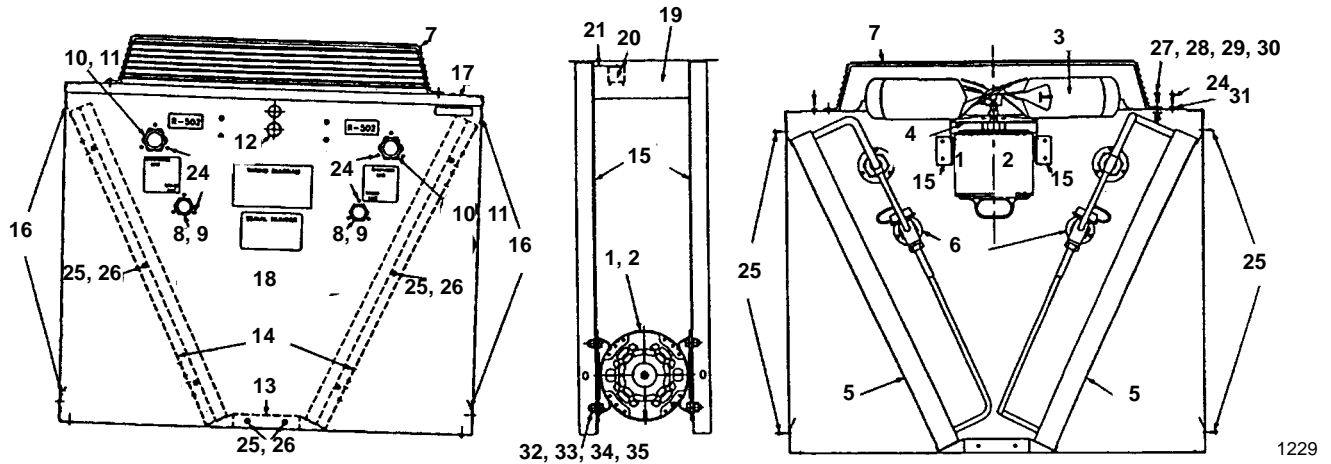

1229

	<b>PART NO.</b>
1 Fan Motor 115V 60 Hz . . . . .	† 76-2942-3
2 Fan Motor 230V 50/60 Hz . . . . .	† 76-2941-3
3 Fan Blade . . . . .	24-1611-3
4 Rain Slinger . . . . .	24-1505-3
5 Air Condenser DC0896A (Uses 2) . . . . .	† 88-5062-9
6 Headmaster Control - R-502 . . . . .	† 83-6806-9
7 Fan Guard . . . . .	34-0064-3
8 Male Coupling, 1-1/8 x 3/8 OD. . . . .	† 83-6036-3
9 Coupling Flange for 83-6036-3 . . . . .	83-6018-3
10 Male Coupling, 1-7/16 - 16 x 1/2 OD . . . . .	† 83-6037-3
11 Coupling Flange for 83-6037-3 . . . . .	83-6017-3
12 Hole Plug for 7/8" Hole. . . . .	43-0146-3
13 Base . . . . .	601779-1
14 Condenser Mounting Angle . . . . .	601777-1
15 Base Bracket for Fan Mounting . . . . .	† 601768-1
16 Support Bracket . . . . .	† 601778-1
17 Top Cover. . . . .	601789-1
18 Front Panel. . . . .	† 601794-1
19 Electrical Box Cover. . . . .	† 601776-1
20 Relay . . . . .	24-0819-3
21 Relay Mounting Bracket. . . . .	600000-1
22 Transformer (Not shown) . . . . .	24-1027-3
23 Electrical Junction Box (Not shown). . . . .	25-1501-3
24 Screw, #10-24 x .62 . . . . .	† 52-0205-9
25 Screw, #8 x .50. . . . .	† 51-2153-9
26 Lockwasher, #8 . . . . .	† 55-4459-9
27 Screw, .25 x .62 . . . . .	† 50-3345-9
28 Lockwasher .25 Split SS . . . . .	† 55-4511-9
29 Washer - Flat .25 SS . . . . .	† 55-7304-9
30 Nut .25-20 Steel Hex . . . . .	† 54-2952-9
31 Lockwasher #10. . . . .	† 55-4464-9
32 Screw, .31-18 x .62 Hex Head . . . . .	† 50-3565-9
33 Nut .31-18 Steel Hex Head . . . . .	† 54-2975-9
34 Washer, Flat .31 ID . . . . .	† 55-7309-9
35 Lockwasher .31 Split Zinc . . . . .	† 55-7313-9
36 Back Panel (Not shown). . . . .	† 601788-1

**NOTE:** Items 20, 21, 22 and 23 are used only when the optional K-00095 Relay/Transformer Kit has been installed.

† Refer to Cross Reference Guide

**INTENTIONALLY LEFT BLANK**